

Identify the type of jewelry you have by the opening. Follow the appropriate instructions. Be sure you read the instructions thoroughly before proceeding.

Things you'll need

- Paper funnel
- Adhesive glue
- Toothpick or similar device to control the distribution of adhesive glue
- A clean area to work on

Filling jewelry with a threaded bale or screw

1.

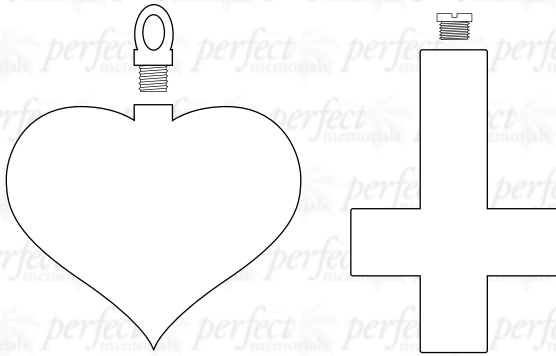

Unscrew the threaded bale or screw.

2.

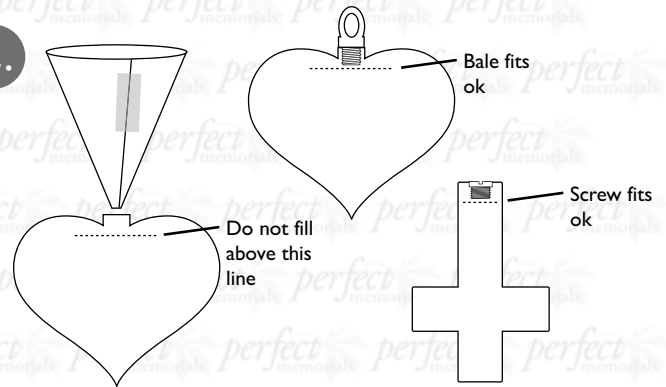

Put the opening of the funnel up to the opening of the pendant. Fill pendant 80% of the way to ensure the screw will fit back in. Make sure the threads look clear and screw in/out the bale to ensure it will close properly.

3.

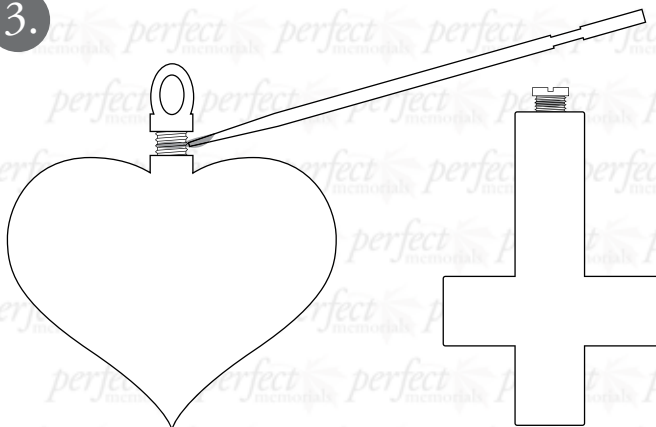

Start screwing the threads into the pendant as shown above. Apply a very small amount of glue to the tip of the toothpick and transfer that to the threads.

4.

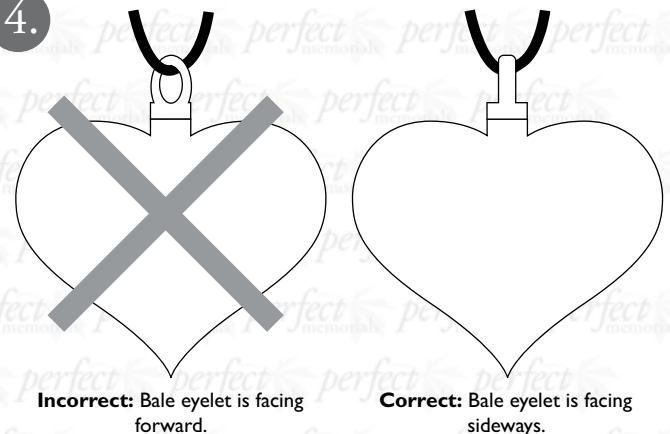

Quickly thread the screw into the pendant. If your jewelry has a bale be sure the eyelet opening is not facing forward. This will cause your pendant to hang incorrectly and twist. The eyelet opening should go sideways as shown in the second illustration above.

5.

You've successfully filled your memorial jewelry. We recommend waiting 24 hours before wearing to ensure the glue is fully dried.

Identify the type of jewelry you have by the opening. Follow the appropriate instructions. Be sure you read the instructions thoroughly before proceeding.

Things you'll need

- Paper funnel
- Adhesive glue
- Toothpick or similar device to control the distribution of adhesive glue
- A clean area to work on

Filling jewelry with a threaded cap

1.



Unscrew the threaded cap.

2.



Put the opening of the funnel up to the opening of the pendant. Fill the pendant slightly below the top of the threads. Make sure the threads look clear and screw on/off the cap to ensure it will close properly before gluing.

3.

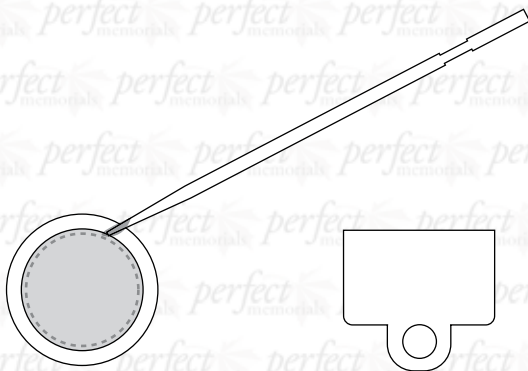

Looking down inside the opening of the threaded cap.

Side view of the threaded cap

Apply a small amount of adhesive to the threads on the inside of the cap.

4.



Place the cap onto the pendant and quickly thread it on.

5.

You've successfully filled your memorial jewelry. We recommend waiting 24 hours before wearing to ensure the glue is fully dried.

1. Cutting the funnel

Cut along the dotted line. Fold the circle so the edges overlap.

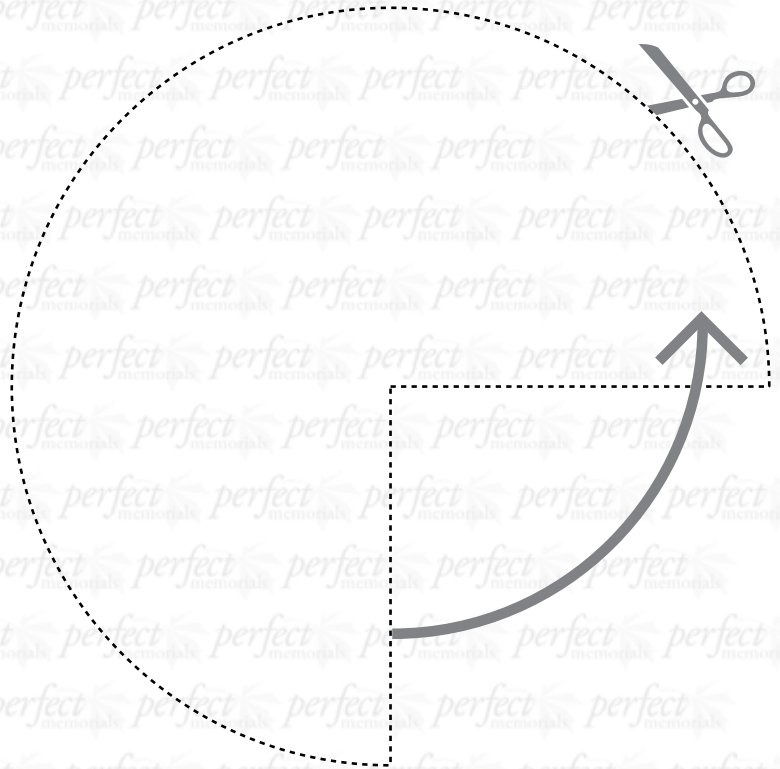

2. Taping and trimming the funnel

Tape or glue the funnel. Use your jewelry to gauge the size of the hole needed in the funnel. Cut the bottom of the funnel off to create the desired hole size. Start small, you can always make it larger.

